

House & Land Package
Lot 2 | 518m²

Milestone 08







This could be considered as one of the smartest plans in the range! Walk in the entry door and you're greeted with an expansive open plan living area and generous kitchen. Its shape and size ensures it fits a huge range of sections and the plan itself suits people of all lifestyles. The stylish façade and cladding options will ensure this plan sits proudly in any location or setting. Main features include:

- A huge stacking sliding door provides access to the outside living area.
- Master bedroom has a walk-in robe and ensuite.
- The modest footprint is efficient on your budget.
- Increased living and scullery options available.

House and Land Package Inclusions:

- Landscaping
- Stormwater Retention Tank
- Fencing
- Clothesline
- Drive and Paths
- Letterbox
- Deck/Patio

Guaranteed Fixed Price and Completion Date.

158m ²	Bedrooms	Bathroom	Ensuite	Living	Garage
	 3	 1	 1	 2	 2

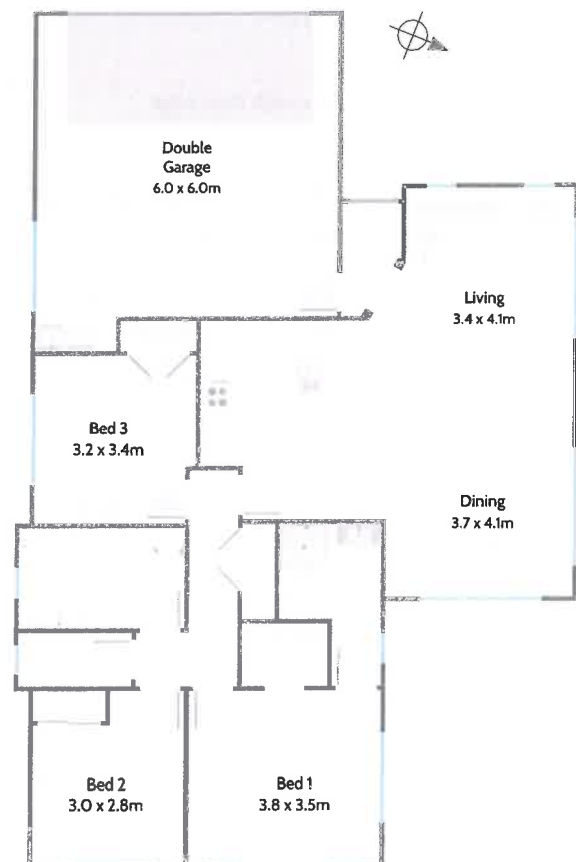

Milestone Homes Otago

📍 6 Silverdale Place, Mosgiel
 📞 03 489 8111 | 0800 MILESTONE
 ✉️ otago@milestonehomes.co.nz
 🌐 milestonehomes.co.nz