

Rates by street address

Last updated: 03 Jul 2025 2:34pm

The table below allows you to find rating information about properties on the Dunedin City Council rating information database.

Please note: The rates for the 2025/2026 year will not be available on the website until later this month. Please call Customer Services on 03 477 4000 or email dcc@dcc.govt.nz for an estimate of the rates for your property.

27 Anderton Crescent Mosgiel

Property Details

Property Details

Valuation number	27841-08126
Rate account ID	4028601
Property number	5124336
Property address	27 Anderton Crescent Mosgiel
Certificate(s) of title	772998

Current Rates

Future Rates

Rates Levied (2026)

Future Rates

The values on which the future rates will be based are the valuations as at 1 July 2022 and will not take effect for rating purposes until 1 Jul 2025.

Future rating year	2026
Future rating period	1 Jul 2025 to 30 Jun 2026
Rateability	Rateable
Rating differential	Area 3 - Residential
Land use	Residential : Single Unit excluding bach
Legal description	LOT 2 DP 508252
Area in hectares	0.0563
Value of improvements (01/07/22)	675,000
Land value (01/07/22)	345,000
Capital value (01/07/22)	1,020,000
Separately used or inhabited parts	1

To request a LIM for this property;

Please note down the valuation number displayed below then follow the instructions on the request a LIM page

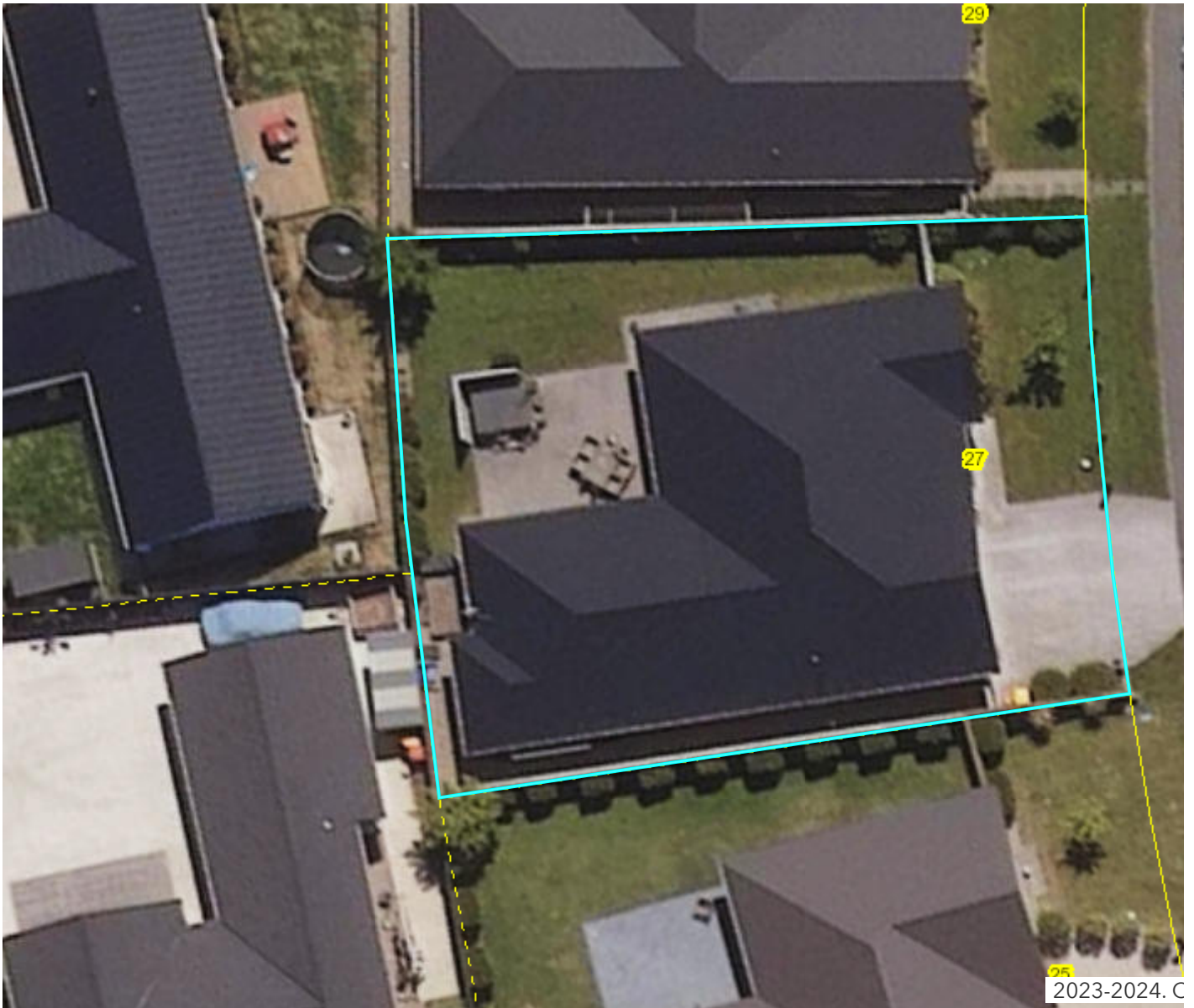
[Search again](#)[Request a LIM](#)

[Map this property](#) (opens a dynamic map viewer in new tab or window).

- [***Rates Information Details***](#)

This rate account information is recorded in the Rating Information Database (RID).

Capital and land values on this site are established by Quotable Value New Zealand Limited, solely for the purpose of levying rates.

[***Learn more about the General Revaluation.***](#)

Future Rates (this will show the new valuation).

The Dunedin City Council's landuse codes have been translated by the Council to a rating differential code.

- **[Disclaimer](#)**

The RID is regularly maintained and therefore is subject to ongoing change.

This information is provided under Section 28 of the Local Government (Rating) Act 2002 as an online representation of our Rating Information Database (RID). The Council Rating Information Database (RID) is freely available to the public at Dunedin City Council, in the same form as is available here. The information presented here is current.

The authoritative source for Certificates of Title is Land Information New Zealand (LINZ). The information provided here is a guide only.

- **[Rating Differential and Land Use](#)**

The Rating differential and land use described herein are the current uses of the rating unit, and not necessarily the District Plan zoning of the property. For all Planning enquiries, please contact the Duty Planner at the Planning Enquiry desk on the 1st floor of the Civic Centre, 50 The Octagon, Dunedin.

For more information about your Privacy, this service and the City of Dunedin website, please see **["Your Privacy & this Site"](#)**.

This service is provided by the Dunedin City Council as a public service. Use of this service to retrieve Rates information constitutes your awareness, and agreement to the **["Conditions of Use"](#)** for this site.

Was this page helpful?

